

PRODUCT BROCHURE

KERN SET-411

Date: 18.03.2025

ENGLISH

Software EasyTouch

SET-411
Hotkeys

EasyTouch hotkeys - shortcut keys and external switches

CONTACT

KERN & SOHN GmbH
Ziegelei 1
72336 Balingen
Germany

Phone : +49 7433 9933-0
Fax : +49 7433 9933-149
Email : info@kern-sohn.com
Web : www.kern-sohn.com

PRODUCT SHOWCASE

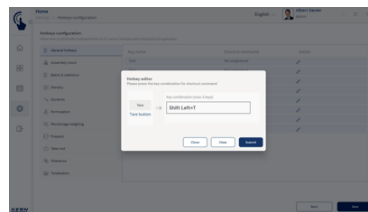
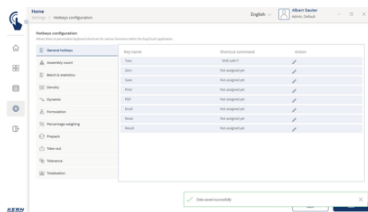
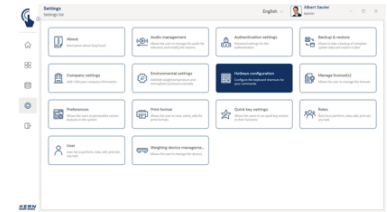
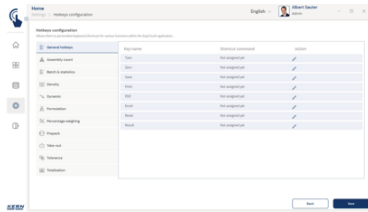

DESCRIPTION

- Note: Prerequisite for this set is the basic program SET-01 Base
- Shortcut keys: Hotkeys allow you to assign key combinations to all buttons in EasyTouch. This simplifies access to frequently used functions considerably, as it means the laborious navigation with the PC mouse is not required. Instead, the actions required can be triggered quickly and directly using the keyboard
- Optional item: Hotkeys is an optional extension of EasyTouch, which supports all active, installed functions. Please note that the price for the additional function does not include any hardware such as switches, buttons or foot pedals
- Configuring shortcut keys: Key combinations can be defined by the system administrator or an authorised person. This means that a clear, user-specific key combination can be defined for any required function
- Versatile hotkey selection: In EasyTouch, you can define general key commands such as “Save” or “Tare” as hotkeys, as well as specific action keys for certain functions. These can then be used in all EasyTouch functions
- Activation using key combination: For example the TARE function can be activated simply and quickly using a key combination
- Integration of external switches or keys: EasyTouch supports the assignment of key combinations to signals

from external HID devices (Human Interface Devices) via USB. This allows the software to be operated via external switches such as emergency stop buttons or foot switches, which enables hands-free operation and increased efficiency. About the process: The external signal is assigned to a key combination in the control software of the standard USB device. This is received by the PC. The signal then activates the assigned EasyTouch function

SPECIFICATIONS





Article codes, product groups & Status information

Model article-code	SET-411
Model-Serie	ETS
Assortment	KERN
Product Type	Software
Product group	EasyTouch
Product usage type	Main item;Accessories/Services
EAN code (Model)	4045761249738
Customs tariff number	85234910

Technical data - Packing & Shipping

Delivery time	1 d
---------------	-----

FUNCTIONS

Standard
   
Option
